

Features :

- Description: Radial leaded fixed inductor (UL sleeved)
 - Applications: Notebook, copying machine, display monitor, ADSL modem, gaming machine, color TV, lightning and car electronics
 - Operating Temperature: -40°C to +100°C
 - Testing: Inductance and Q are tested on an HP4284A at specified frequency.
 - Packaging: Bulk pack; packaged in styrofoam.
 - Marking: Marked with inductance code.
 - Additional info available upon request.
- *Custom current rating(IDC) are available upon request.

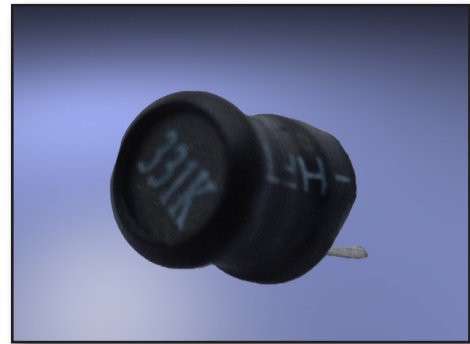

Part Number	Inductance (μ H)	Q	Q Test Frequency (mHz)	SRF (MHz)	DCR Max. (Ohm)	IDC (mA)
AXR0810LB-1R0M_	1.0	90	7.96	100	0.02	3400
AXR0810LB-1R2M_	1.2	90	7.96	90	0.02	3400
AXR0810LB-1R5M_	1.5	95	7.96	80	0.02	3400
AXR0810LB-1R8M_	1.8	95	7.96	75	0.03	3300
AXR0810LB-2R2M_	2.2	100	7.96	70	0.03	3000
AXR0810LB-2R7M_	2.7	110	7.96	60	0.04	3000
AXR0810LB-3R3M_	3.3	110	7.96	56	0.04	3000
AXR0810LB-3R9M_	3.9	110	7.96	52	0.05	2900
AXR0810LB-4R7M_	4.7	110	7.96	30	0.05	2900
AXR0810LB-5R6M_	5.6	100	7.96	30	0.06	2600
AXR0810LB-6R8M_	6.8	90	7.96	20	0.06	2500
AXR0810LB-8R2M_	8.2	80	7.96	17	0.06	2000
AXR0810LB-100K_	10.0	90	2.52	12	0.10	3500
AXR0810LB-120K_	12.0	90	2.52	11	0.10	3500
AXR0810LB-150K_	15.0	90	2.52	10	0.10	3200
AXR0810LB-180K_	18.0	80	2.52	9.0	0.11	3200
AXR0810LB-220K_	22.0	70	2.52	8.0	0.13	3000
AXR0810LB-270K_	27.0	70	2.52	7.0	0.14	2800
AXR0810LB-330K_	33.0	70	2.52	7.0	0.16	2500
AXR0810LB-390K_	39.0	70	2.52	6.0	0.16	2250
AXR0810LB-470K_	47.0	70	2.52	5.5	0.16	2000
AXR0810LB-560K_	56.0	60	2.52	5.5	0.22	1800
AXR0810LB-680K_	68.0	60	2.52	5.0	0.23	1500
AXR0810LB-820K_	82.0	60	2.52	4.5	0.27	1250
AXR0810LB-101K_	100	40	0.796	4.5	0.29	1000
AXR0810LB-121K_	120	40	0.796	4.5	0.33	1000
AXR0810LB-151K_	150	40	0.796	4.5	0.46	850
AXR0810LB-181K_	180	40	0.796	4.0	0.51	850
AXR0810LB-221K_	220	40	0.796	3.5	0.62	800
AXR0810LB-271K_	270	30	0.796	3.0	0.65	800

*Custom current rating (IDC) value

Tolerance Code K= $\pm 10\%$, M= $\pm 20\%$

Part Number	Inductance (μ H)	Q	Q Test Frequency (mHz)	SRF (MHz)	DCR Max. (Ohm)	IDC (mA)
AXR0810LB-331K_	330	30	0.796	3.0	0.79	700
AXR0810LB-391K_	390	30	0.796	2.5	0.91	700
AXR0810LB-471K_	470	30	0.796	2.5	1.2	650
AXR0810LB-561K_	560	30	0.796	2.0	1.2	650
AXR0810LB-681K_	680	30	0.796	2.0	1.5	550
AXR0810LB-821K_	820	25	0.796	2.0	1.7	500
AXR0810LB-102K_	1000	50	0.252	2.0	2.0	450
AXR0810LB-122K_	1200	45	0.252	1.5	2.3	450
AXR0810LB-152K_	1500	45	0.252	1.5	2.9	400
AXR0810LB-182K_	1800	45	0.252	1.5	3.5	400
AXR0810LB-222K_	2200	50	0.252	1.0	4.2	360
AXR0810LB-272K_	2700	50	0.252	1.0	5.1	360
AXR0810LB-332K_	3300	50	0.252	0.9	6.1	280
AXR0810LB-392K_	3900	50	0.252	0.8	7.8	280
AXR0810LB-472K_	4700	55	0.252	0.7	11.0	260
AXR0810LB-562K_	5600	55	0.252	0.6	11.0	260
AXR0810LB-682K_	6800	55	0.252	0.6	14.0	240
AXR0810LB-822K_	8200	60	0.252	0.6	15.0	240
AXR0810LB-103K_	10000	100	0.0796	0.5	20.0	180
AXR0810LB-123K_	12000	100	0.0796	0.4	24.0	180
AXR0810LB-153K_	15000	100	0.0796	0.4	28.0	180
AXR0810LB-183K_	18000	100	0.0796	0.4	42.0	140
AXR0810LB-223K_	22000	100	0.0796	0.3	43.0	140
AXR0810LB-273K_	27000	100	0.0796	0.3	55.0	140
AXR0810LB-333K_	33000	90	0.0796	0.2	65.0	140
AXR0810LB-393K_	39000	90	0.0796	0.2	87.0	100
AXR0810LB-473K_	47000	85	0.0796	0.2	98.0	100
AXR0810LB-563K_	56000	80	0.0796	0.2	128	100
AXR0810LB-683K_	68000	70	0.0796	0.2	141	80
AXR0810LB-823K_	82000	70	0.0796	0.2	161	80
AXR0810LB-104K_	100000	55	0.0796	0.2	180	80

*Custom current rating (IDC) value

Tolerance Code K= $\pm 10\%$, M= $\pm 20\%$

Dimensions :

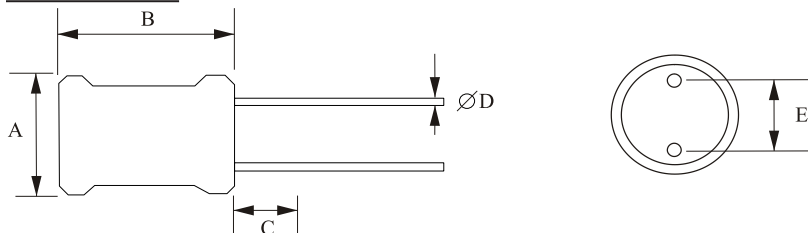

Size	A (max)	B ± 1	C ± 0.3	D ± 0.5	E ± 0.5
mm	9.0	12.0	15.0	0.6	5.0

Specifications are subject to change without notice.

Customers should verify actual device performance in their specific applications.